

The Home Gym address is:

Town & County Gym

5150 E. 101st Street
Tulsa, OK 74137

Directions: The gym is about 1/4 mile east of 101st and Yale on the south side of the street. If taking the Creek turnpike, take the Yale exit, go south about 1/2 mile and turn east on 101st Street.

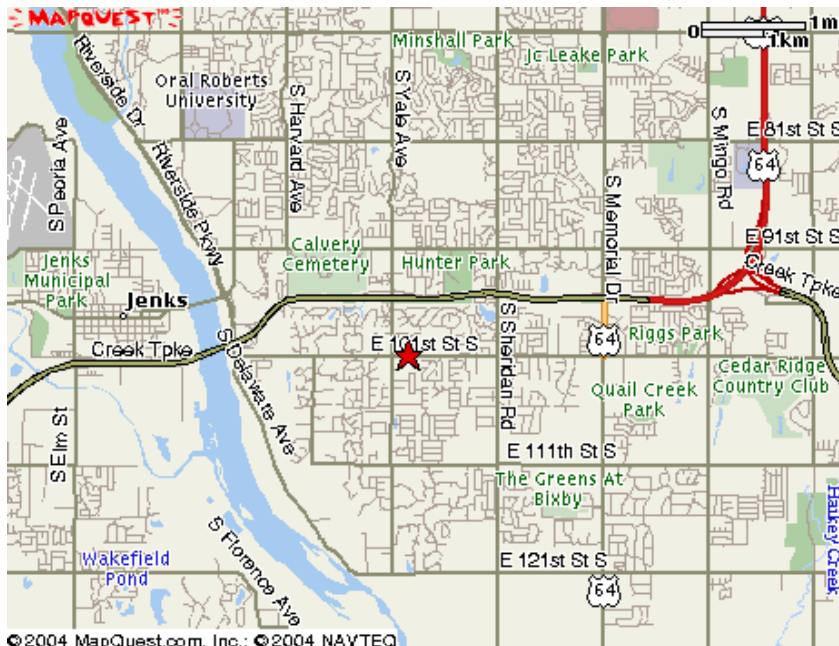

Skelly Drive Baptist Church Gym

8504 East Skelly Dr., Tulsa, OK

Directions: The gym is on the ONE-WAY service road (going east) just past the car dealers. You get on the service road (Skelly Dr.) from Memorial--just north of 31st Street.

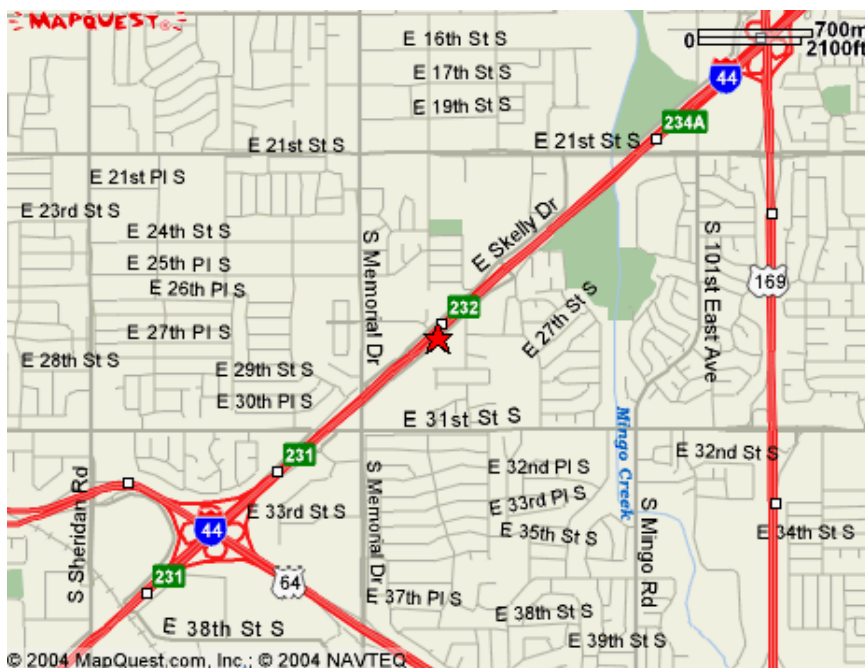

Freedom Baptist Church Gym

9602 N 177th East Ave, Owasso, OK

Directions: Get on 169 North to Owasso. Exit 96th Street North and go east to just before 177th East Avenue. The gym is on the northwest corner of the intersection.

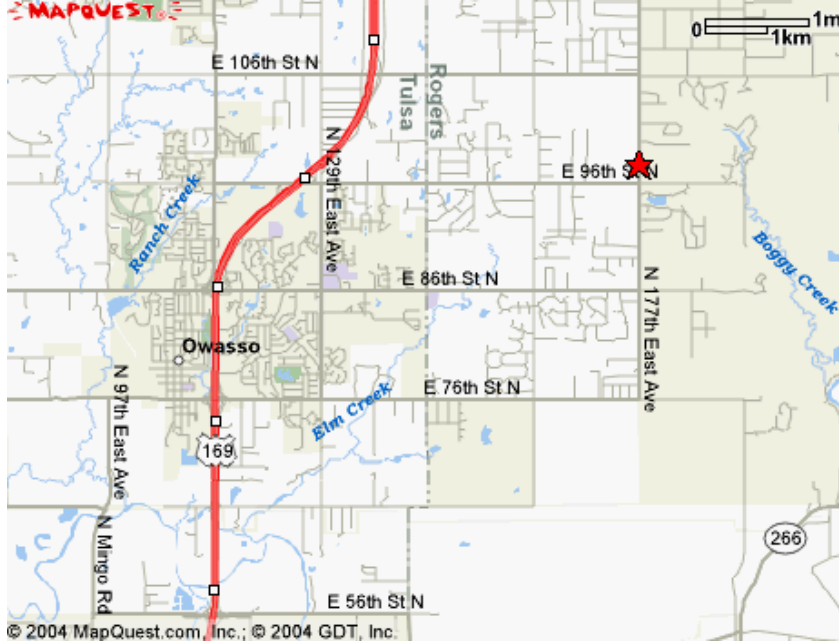

Calvary Church of the Nazarene/CEA Gym

840 W 81st St, Tulsa, OK

Directions: From north: Take I-44 to U.S.75, go south and exit on 81st Street. Turn east and go about a 1/4 mile. Church gym is on the south side of 81st Street.
From south: Go north on U.S.75 and exit on 81st Street turn east. Church is about a 1/4 mile on the right. Church gym is on the south side of 81st Street.

